

GENERAL NOTES:

1. COBRA HEAD LUMINAIRE SHALL BE INSTALLED AT THE INTERSECTION AND ACORN STYLED LUMINAIRE SHALL BE INSTALLED ALONG THE CORRIDOR UNLESS OTHERWISE NOTED.

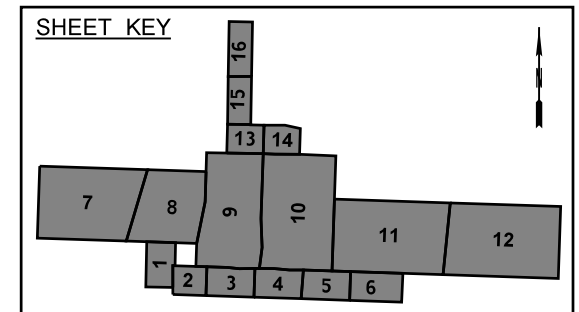

CODE	REVISION DESCRIPTION	DATE	BY	PROJ. MANGER: EHS

DESIGNED BY: AHC
 DRAFTED BY: JLB
 CHECKED BY: CLM
 PROJ. MANGER: EHS



WSP USA Inc.
 33301 9th Avenue South
 Suite 300
 Federal Way, WA 98003-2600
 TEL: (206) 431-2300
 FAX: (206) 431-2250

PRELIMINARY

**INTERSTATE 5
 PORT OF TACOMA ROAD INTERCHANGE
 ILLUMINATION PLAN**

PLAN NUMBER
IL01
 SHEET #
 OF #
 SHEETS

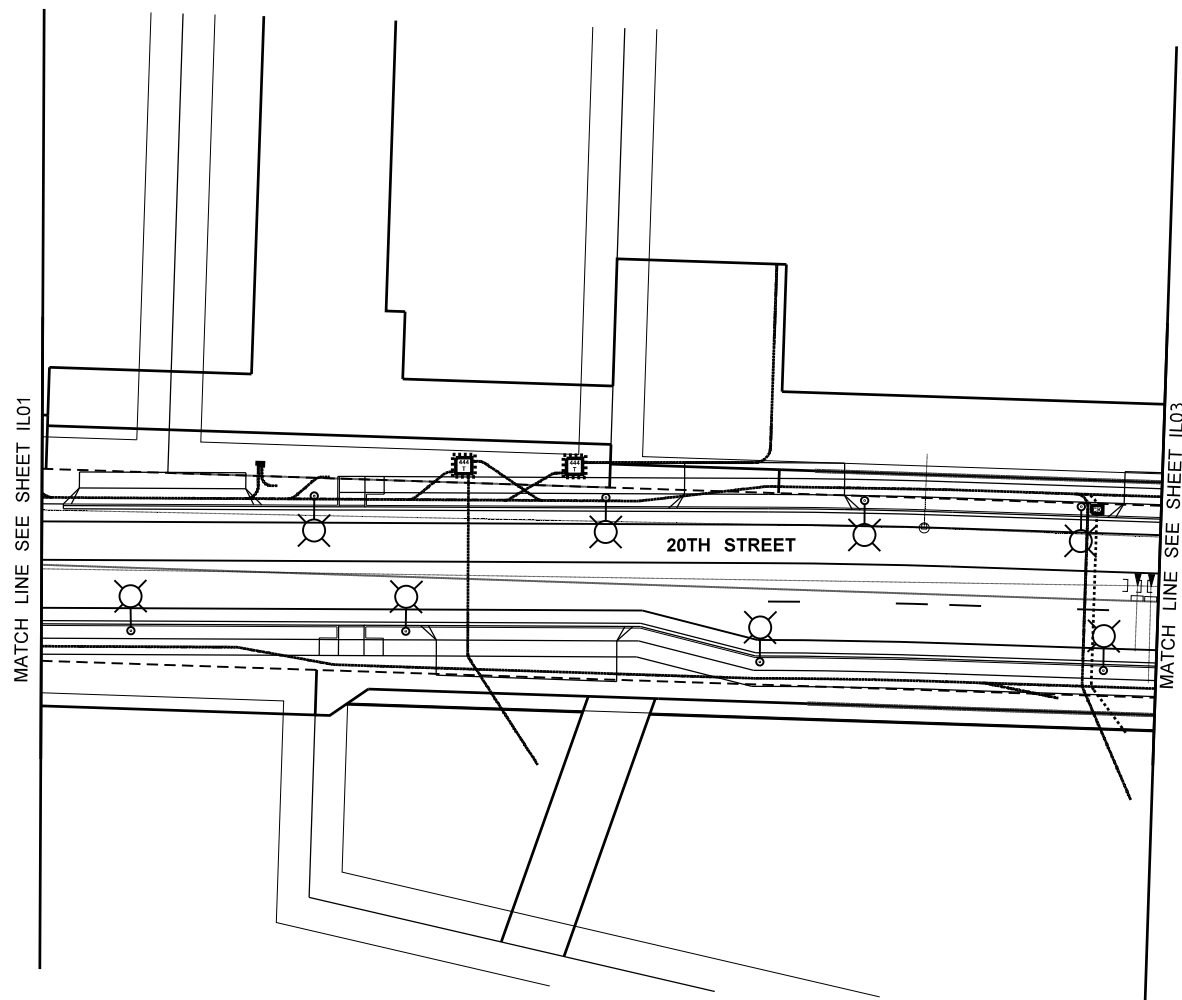

GENERAL NOTES:

1. COBRA HEAD LUMINAIRE SHALL BE INSTALLED AT THE INTERSECTION AND ACORN STYLED LUMINAIRE SHALL BE INSTALLED ALONG THE CORRIDOR UNLESS OTHERWISE NOTED.

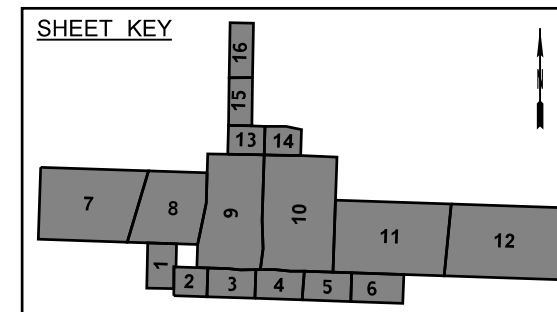
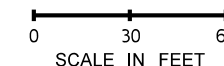

CODE	REVISION DESCRIPTION	DATE	BY	PROJ. MANGER:
				EHS

DESIGNED BY: AHC
 DRAFTED BY: JLB
 CHECKED BY: CLM
 PROJ. MANGER: EHS



WSP USA Inc.
 33301 9th Avenue South
 Suite 300
 Federal Way, WA 98003-2600
 TEL: (206) 431-2300
 FAX: (206) 431-2250

PRELIMINARY

**INTERSTATE 5
 PORT OF TACOMA ROAD INTERCHANGE
 ILLUMINATION PLAN**

PLAN NUMBER
IL02
 SHEET #
 OF #
 SHEETS

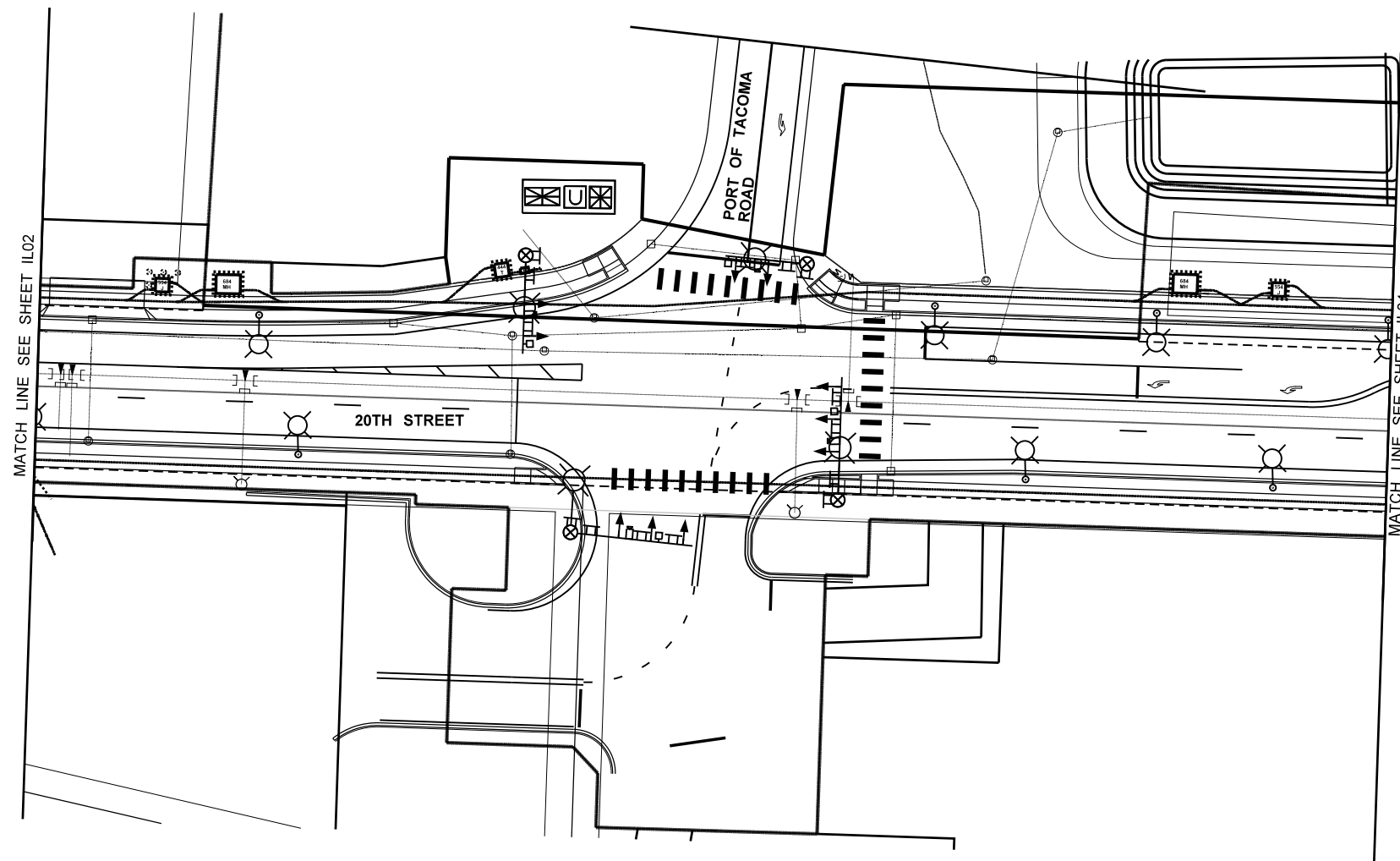

GENERAL NOTES:

1. COBRA HEAD LUMINAIRE SHALL BE INSTALLED AT THE INTERSECTION AND ACORN STYLED LUMINAIRE SHALL BE INSTALLED ALONG THE CORRIDOR UNLESS OTHERWISE NOTED.

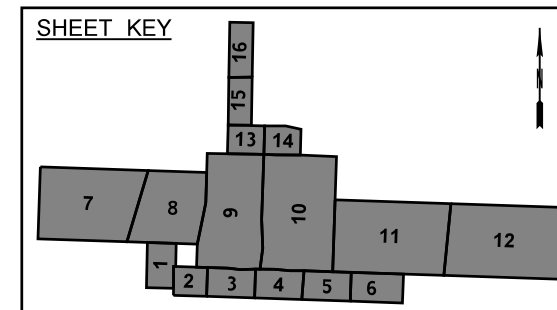
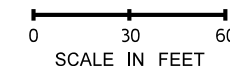

CODE	REVISION DESCRIPTION	DATE	BY

DESIGNED BY: AHC
 DRAFTED BY: JLB
 CHECKED BY: CLM
 PROJ. MANGER: EHS



WSP USA Inc.
 33301 9th Avenue South
 Suite 300
 Federal Way, WA 98003-2600
 TEL: (206) 431-2300
 FAX: (206) 431-2250

PRELIMINARY

**INTERSTATE 5
 PORT OF TACOMA ROAD INTERCHANGE
 ILLUMINATION PLAN**

PLAN NUMBER
IL03
 SHEET #
 OF #
 SHEETS

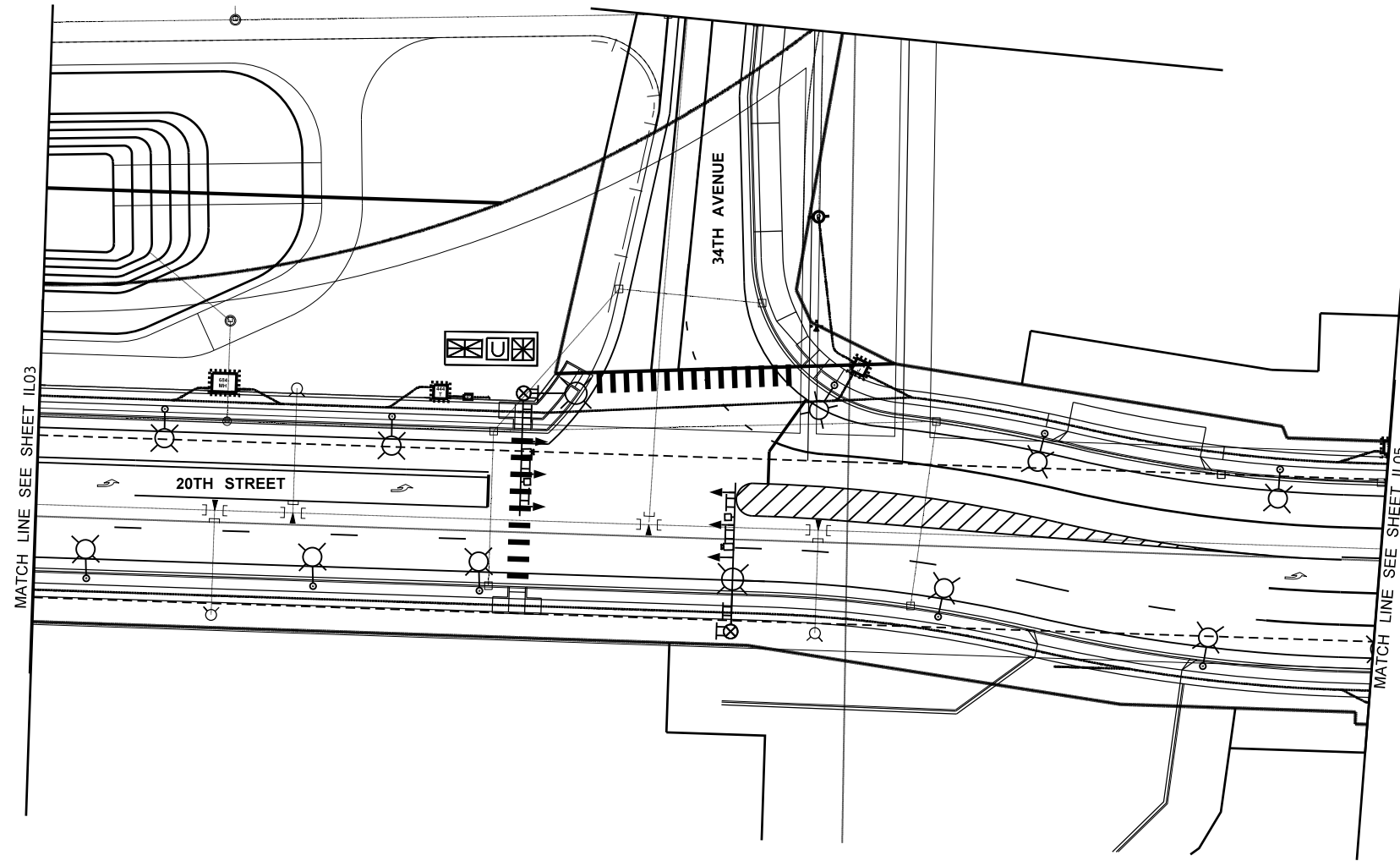

GENERAL NOTES:

1. COBRA HEAD LUMINAIRE SHALL BE INSTALLED AT THE INTERSECTION AND ACORN STYLED LUMINAIRE SHALL BE INSTALLED ALONG THE CORRIDOR UNLESS OTHERWISE NOTED.

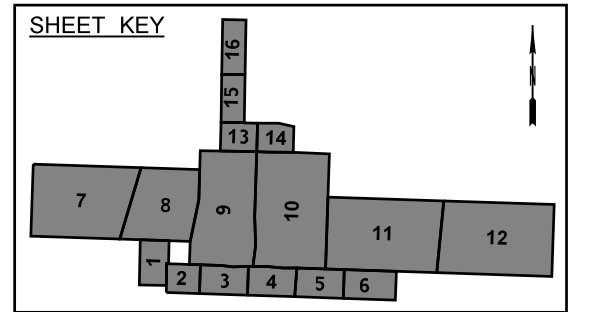
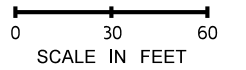

CODE	REVISION DESCRIPTION	DATE	BY	PROJ. MANGER: EHS

DESIGNED BY: AHC
 DRAFTED BY: JLB
 CHECKED BY: CLM
 PROJ. MANGER: EHS



WSP USA Inc.
 33301 9th Avenue South
 Suite 300
 Federal Way, WA 98003-2600
 TEL: (206) 431-2300
 FAX: (206) 431-2250

PRELIMINARY

**INTERSTATE 5
 PORT OF TACOMA ROAD INTERCHANGE
 ILLUMINATION PLAN**

PLAN NUMBER
IL04
 SHEET #
 OF #
 SHEETS

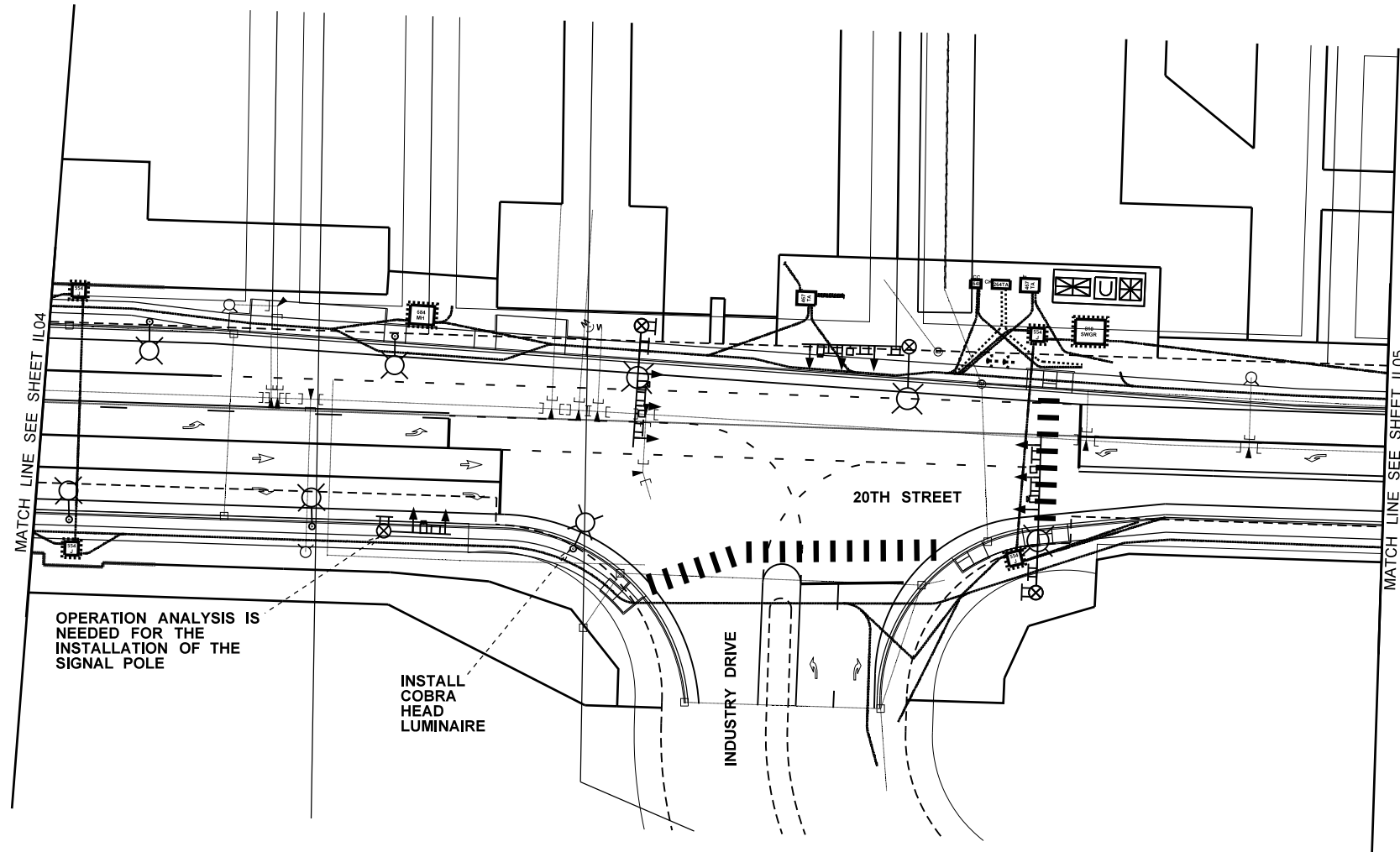

GENERAL NOTES:

1. COBRA HEAD LUMINAIRE SHALL BE INSTALLED AT THE INTERSECTION AND ACORN STYLED LUMINAIRE SHALL BE INSTALLED ALONG THE CORRIDOR UNLESS OTHERWISE NOTED.

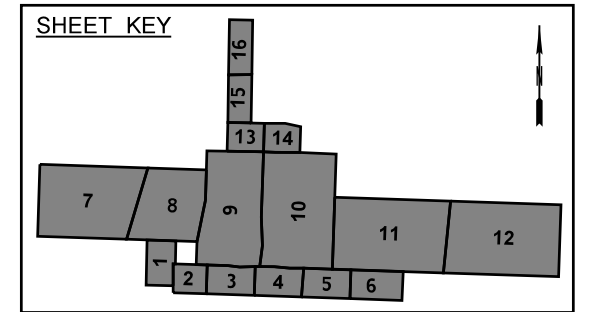
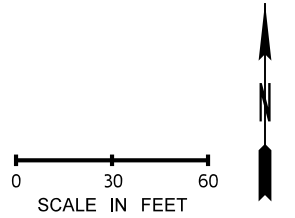

CODE	REVISION DESCRIPTION	DATE	BY

DESIGNED BY: AHC
DRAFTED BY: JLB
CHECKED BY: CLM
PROJ. MANGER: EHS

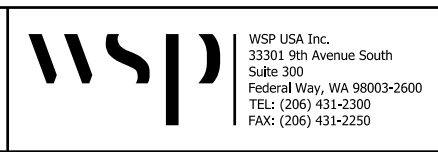

PRELIMINARY

**INTERSTATE 5
PORT OF TACOMA ROAD INTERCHANGE
ILLUMINATION PLAN**

PLAN NUMBER IL05
SHEET # OF # SHEETS

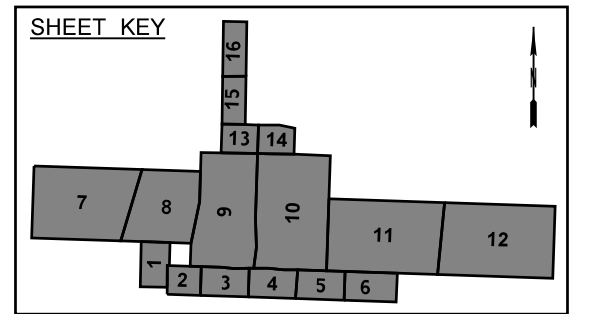
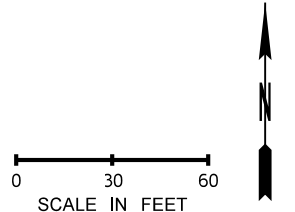
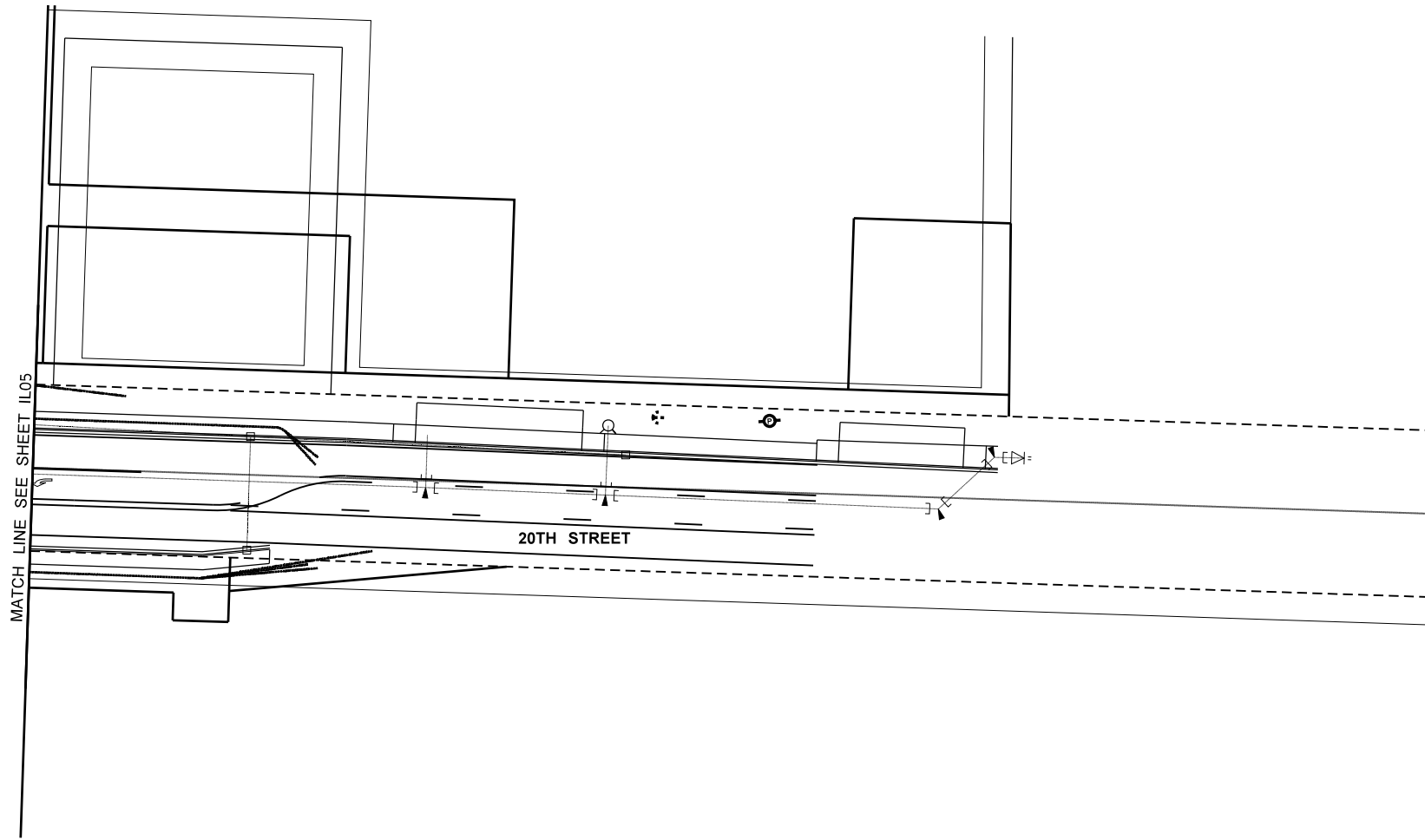

CODE	REVISION DESCRIPTION	DATE	BY	PROJ. MANGER: EHS

DESIGNED BY: AHC
DRAFTED BY: JLB
CHECKED BY: CLM
PROJ. MANGER: EHS



WSP USA Inc.
 33301 9th Avenue South
 Suite 300
 Federal Way, WA 98003-2600
 TEL: (206) 431-2300
 FAX: (206) 431-2250

PRELIMINARY

**INTERSTATE 5
 PORT OF TACOMA ROAD INTERCHANGE
 ILLUMINATION PLAN**

PLAN NUMBER IL06
SHEET # OF # SHEETS